







INDEX

- 03 PRODUCTION ARBOR
- 04 SIMPLIST SERIES: SIMPLY WOOD
- 06 FLAT SERIES: WOOD-ALUMINUM
- 07 MINIMA SERIES: WOOD-ALUMINUM
- 08 ANTIQUE SURFACE
- 09 ELEGANT LINES
- 11 WINDOW MODELS
- 12 STANDART WINDOWS
- 13 STUDIO WINDOWS
- 14 PATIO DOORS
- 15 PIVOT WINDOWS/ARCHED WINDOWS
- 16 SLIDERS
- 17 SHUTTERS
- 18 SASH WINDOWS
- 19 TILT AND SLIDE SASH WINDOWS
- 20 ACCESSORIES
- 21 AUXILIARY WOODEN ELEMENTS
- 22 ENTRANCE DOORS
- 29 INTERIOR DOORS
- 36 IRON MONGERY
- 37 SUSTAINABLY SOURCED WOOD...
- 38 STAIN COLOURS
- 40 HESITATIONS ABOUT WOOD



PRODUCTION

Each level of production has been highly automated at Time to Build. All processes, from profiling to joining, painting and assembly of glass and accessories, are made by standardized and mechanized means. These processes, performed by German and Italian machinery, are controlled and supervised by an online computerized management system. The temperature and humidity in factory area are kept under strict automatic control. In this way, all of the processes are performed in standard ways until the finished product is reached, which means minimization of human mistakes.

SIMPLISTSERIES

SIMPLY WOOD

SIMPLIST windows are of complete wood, laminated in three plies.

They are produced in 3 different thicknesses, 68, 78 and 90 mm with different performances.

Air, water and wind resistance: Air class 4 / Water class 9A / Wind class C3.

**TIMEto
BUILD**



68s



68 mm

68s Uw VALUE TABLE			
Uf =		1.40	
ϵ_n	ψ_g	0,029	0,081
1.0		1,20	1,33
1.1		1,27	1,40
1.3		1,41	1,54
2.6		2,28	2,41
2.7		2,35	2,48
Max glazing=		28 mm	

The thermal and acoustic insulation values of Time to Build products have been tested and reported by ift Rosenheim Institute in Germany.

78s



78 mm

78s Uw VALUE TABLE			
Uf =		1.28	
ϵ_n	ψ_g	0,027	0,086
0.6		0,89	1,04
0.7		0,96	1,10
ϵ_n	ψ_g	0,029	0,081
1.0		1,16	1,29
1.1		1,23	1,36
1.3		1,37	1,50
2.6		2,24	2,37
2.7		2,31	2,44
Max glazing=		40 mm	

High thermal and acoustic insulation values are reached by 78s thanks to its improved design and the triple insulation glasses that can be used with acoustic laminates.

90s

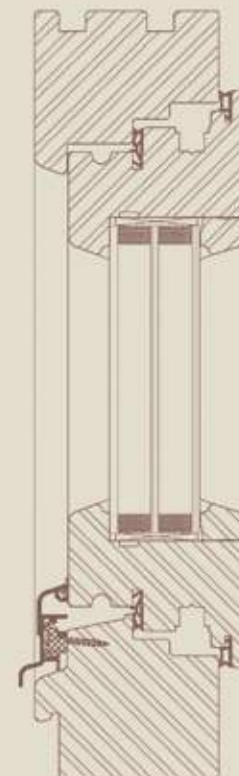

90 mm

90s Uw VALUE TABLE			
Uf =		1.15	
ϵ_n	ψ_g	0,027	0,086
0.6		0,85	1,00
0.7		0,91	1,06
ϵ_n	ψ_g	0,029	0,081
1.0		1,12	1,25
1.1		1,19	1,32
1.3		1,32	1,45
2.6		2,20	2,33
2.7		2,27	2,40
Max glazing=		52 mm	

The absolute solution for passive houses. The high thermal requirements in Europe like Passivhouse, BBC and Minergie are easily reached by 90s.

**TIMEto
BUILD**

FLATSERIES

WOOD-ALUMINUM

68f windows, being cladded with aluminum as a flat surface get integrated with modern architectural elements at exterior, while being completely natural construction products at heart.



68f



68 mm

68f Uw VALUE TABLE		
Uf =	1.3	
ψg =	0,028	0,097
0.6	0,90	1,08
0.7	0,97	1,14
ψg =	0,031	0,092
1.0	1,18	1,33
1.1	1,24	1,40
1.3	1,38	1,53
2.6	2,24	2,39
2.7	2,31	2,46
Max glazing=	52 mm	



The versatility of design lets us integrate double as well as triple insulation glass units with laminations upto 52 mm total thickness. Thermal and sound insulation values are very high with 68f windows, thanks to the three peripheric and continuous joints of EPDM and Q-LON. Please refer to our technical documentation for further details.

MINIMASERIES

WOOD-ALUMINUM

68m windows have their sashes concealed. The aluminum cladding stand as a single surface at the exterior. The patented joint line between sash and frame offer very high performance of insulation.



68m

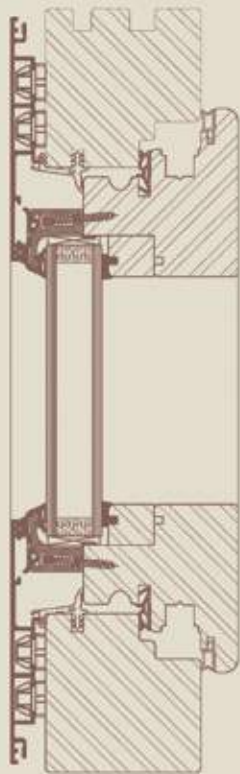

68 mm

68m Uw VALUE TABLE		
Uf =	1.2	
Ug = $\psi_g =$	0,028	0,097
0.6	0.86	1,04
0.7	0,93	1,10
Ug = $\psi_g =$	0,031	0,092
1.0	1,14	1,30
1.1	1,21	1,36
1.3	1,35	1,50
2.6	2,23	2,38
2.7	2,30	2,45
Max glazing=	52 mm	

The 68m windows epitomize the spirit of challenge for Fenex. Astonishingly high performances are reached while keeping a clear and simple appearance. The three peripheric and continuous joints of EPDM and Q-LON guarantees excellent tightness against air and water. Please refer to our technical documentation for further details.

ANTIQUE SURFACE

"Antique Surface" is a special technique of Time to Build, which emphasizes the natural texture of oak, providing an antique appearance. This is made by a mechanical process on wood surface.

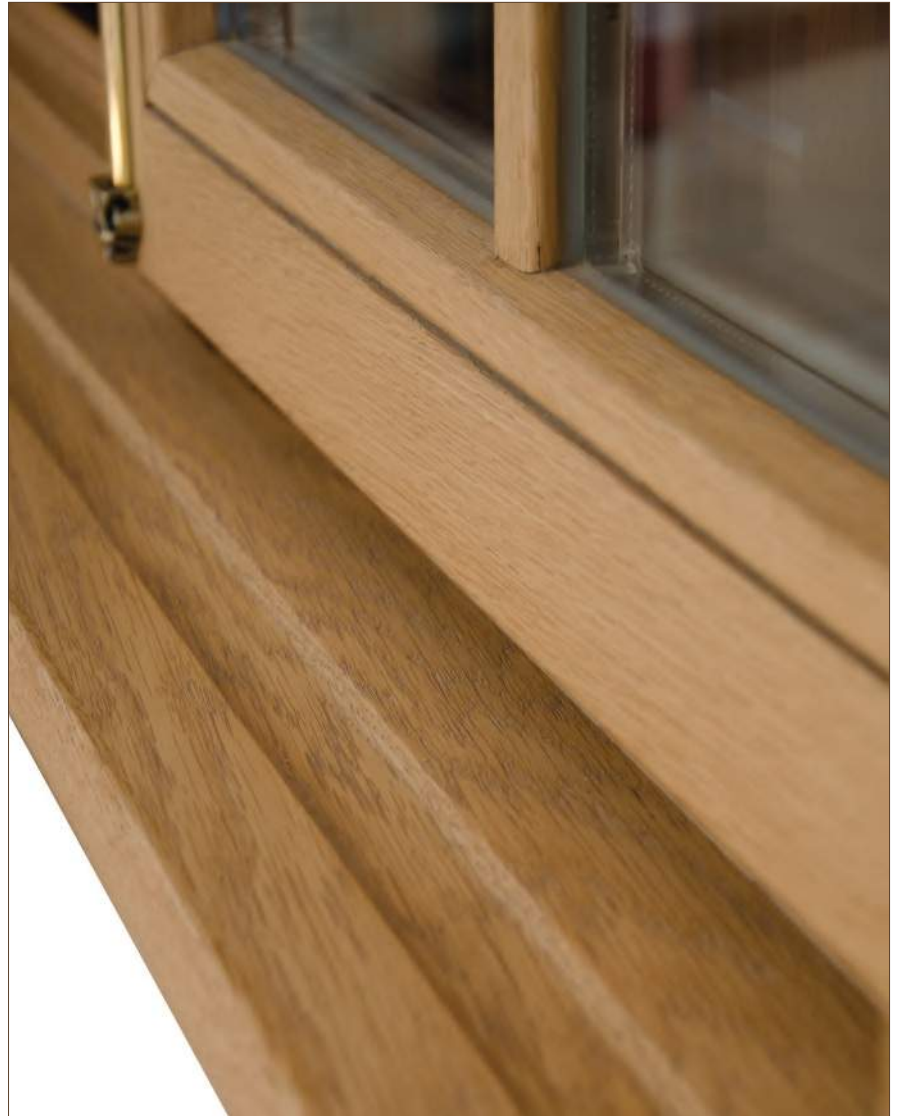

ELEGANTLINES

We offer the below options of profiles for use in windows to satisfy different tastes.

EXTERIOR GLAZING BARS AND BEADS

Standard

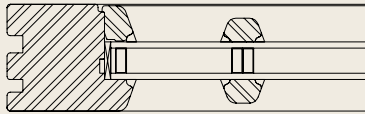

Putty

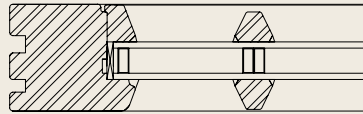

Rustic

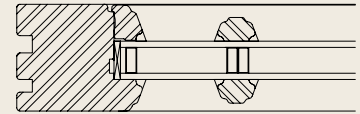

Lamb's tongue

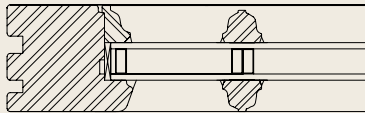

Ogee

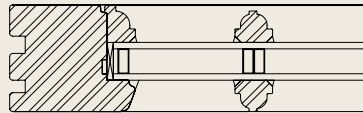

Concave

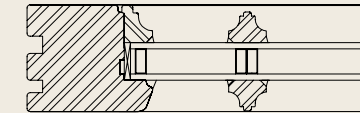

VV
TIMEto
BUILD



WINDOW MODELS

It is practically certain that there is a suitable window solution at Time to Build for every opening. Since one will usually find more than one alternative, it is important to determine requirements well.

Although wood provides wider possibilities than uPVC, there are still dimensional limitations that should be taken into consideration about Fenex products. These limitations are meant to ensure the lifetime maintenance of vital window functions. Our sales representatives will direct your preferences in these ways.



Our production capabilities are not limited to these windows. Any window you imagine means an "order" for us to fabricate. Please consult us to undertake your needs for special windows beyond our standard models.

STANDARD WINDOWS

Here, you can find several examples of rectangular windows, commonly used in contemporary buildings.

Our standard window sashes open with espagnolettes. Sashes can be delivered with tilt and turn or simple espangolettes according to demand. As an alternative to this opening system, sash windows with vertically sliding sashes can be provided in the scope of special production.



STUDIOWINDOWS

These windows are made to solve problems related to those flats under inclined roofs or just to fulfill extra-ordinary architectural tastes.

Our standard window sashes open with espagnolettes. Sashes can be delivered with tilt and turn or simple espagnolettes according to demand.

Aluminum cladding, which provides life-long solution for exterior window surfaces is possible for all our windows.

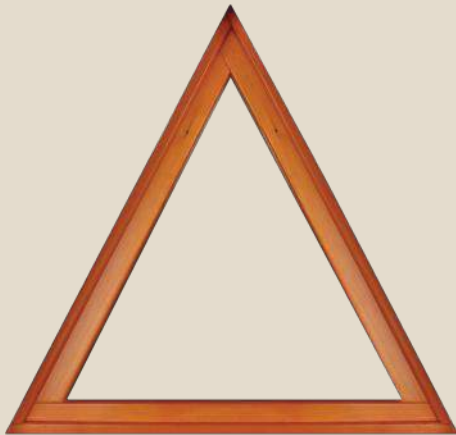
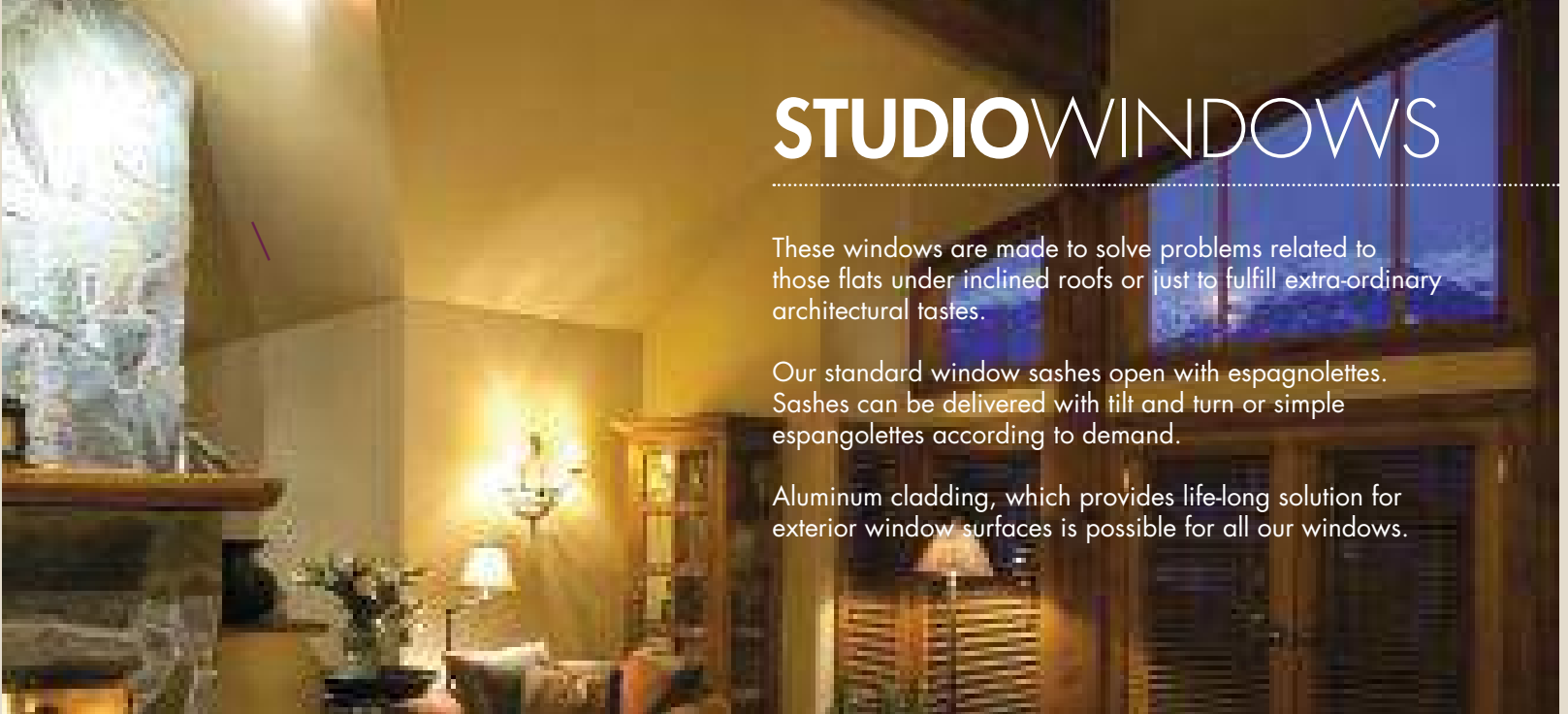

PATIO DOORS

Our patio doors have similar properties to windows in terms of construction and mechanisms but differ from other windows by the corrosion resistant doorstep system special to Time to Build. On patio doors, lock keys and special handle options are provided which are not used on regular windows.

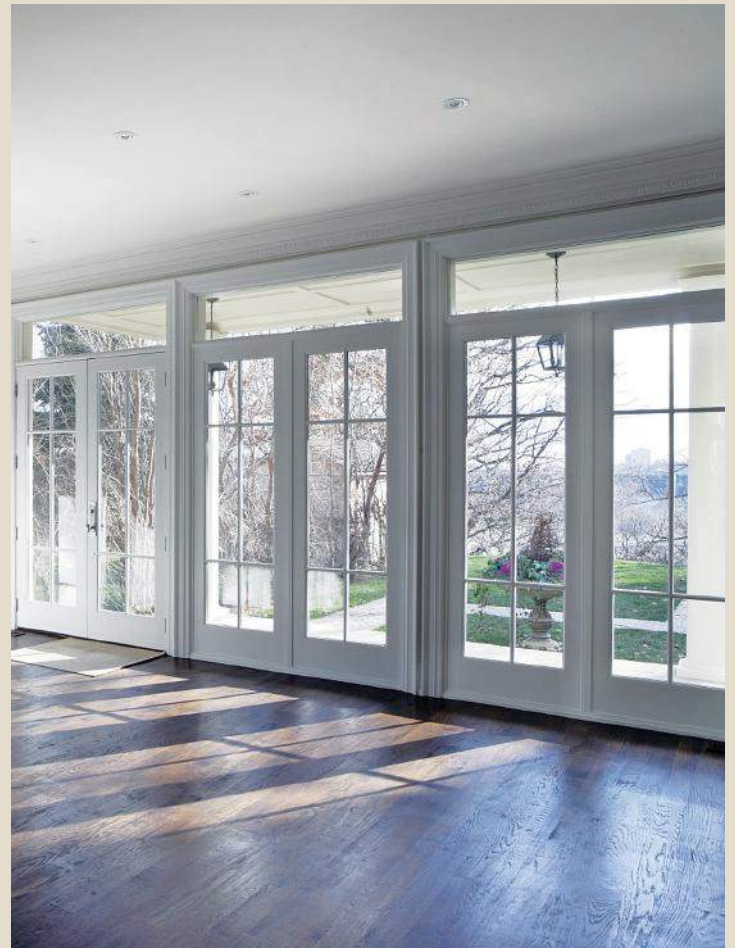

PIVOTWINDOWS

This window type is an example of the wide industrial capabilities of Fenex. Pivot windows, usually preferred as oval, may be used in children rooms for safety, in other bedrooms for privacy, in triangular under-roof wall ends or for any architectural preferences for the sake of the ambience they create.

Pivot windows are produced with special mechanisms because of their peculiar opening style.

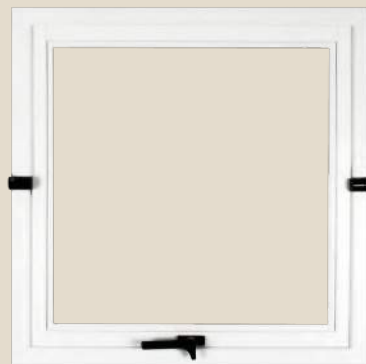

ARCHEDWINDOWS

Arched windows are extensively used in classical architecture. The arches used in ancient buildings comprises various oval shapes like a circle-top transom or a semi-circle or a Gothic top. The examples you see here reflect some of these cases.



SLIDERS

It is possible to utilize wide openings thanks to sliding window and door systems. Saving space, maximizing view and obtaining an outdoors feeling inside are among the advantages provided by sliding windows. Sliding systems are commonly preferred for doors opening to patios, gardens and balconies.

We offer different sliding styles with different mechanisms such as folding, lift-slide and tilt-and-slide. Decision must be made according to the expectations. Folding windows and doors have inter-hinged sashes that fold and stack smoothly on a side. Lift-slide windows and doors have strong fittings that lift the sash to slide open from a small distance to full width and may be fixed by lowering in any position. Tilt-and-slide mechanism requires moving the sash in and outwards when opening and closing. It is also possible to leave the sash in tilt position, to provide safe and secure ventilation.



SHUTTERS

Some say that it is the shutter that makes a window beautiful. We produce improved systems of real wood shutters. They not only add to the appearance to facades but also have functions of increasing security and protecting windows against sun.

Our shutters can be locked both at open and closed positions. The louvers may be fixed or tilt. Tilting louvers enable to control sunlight and vision even with the shutter in closed position.

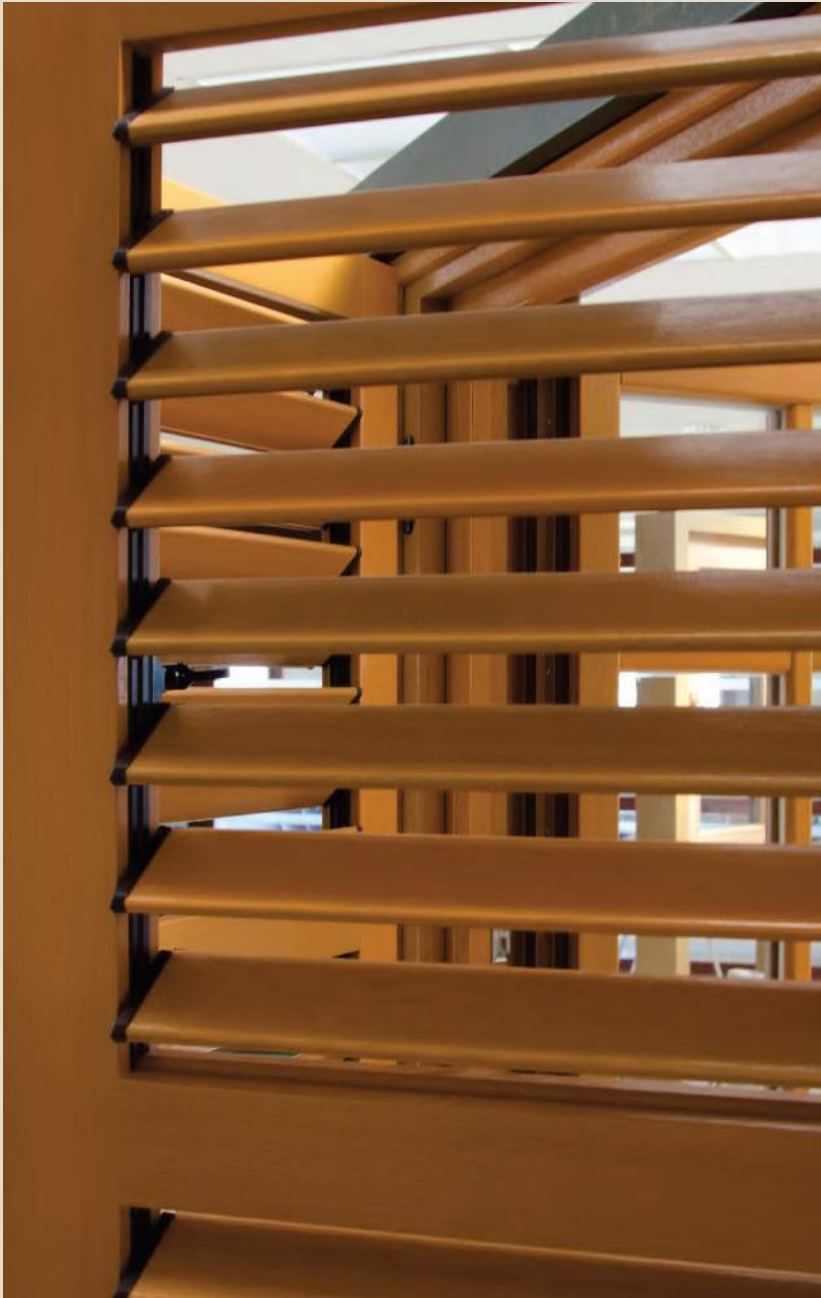

SASHWINDOWS

Windows with vertically moving sashes are called "Sash Windows".

Modern mechanisms have made sash windows as practical and safe to use as they have never been before.

Besides being used in period buildings, sash windows are also employed in new residences for the sake of practicality and architectural concerns all around Europe.

The traditional way to move a sash is to use cords and weights.

A modern mechanism, consisting of stainless steel springs placed in a pipe of 16-26 cm diameter is able to move a 45 kg sash simply by your fingers and to leave it at any position you like. Historical sash mechanisms, on the other hand, continue to draw attentions with many examples still working on period buildings from 19th and 18th centuries.

The common practice in many countries is to conserve period buildings by controlling renovation works and therefore, replacement of historic windows must replicate the detailing of the originals. Time to Build manufactures sash windows with modern mechanisms for both contemporary and historic buildings.

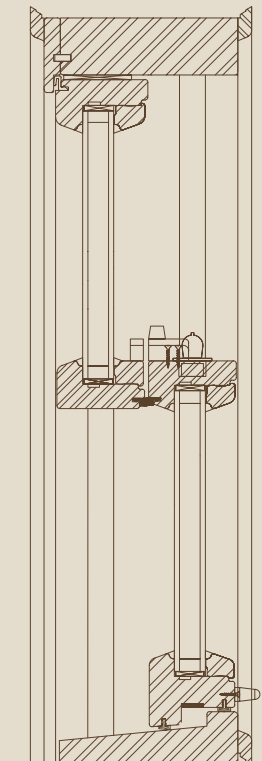

TILT AND SLIDE SASH WINDOWS

Cleaning may be difficult for sash windows.

Tilting double hung windows incorporate sashes that tilt smoothly in. This is an addition to their normal vertical operation. Tilting enables safe ventilation and easy cleaning.

A double hung window with both sashes tilting is shown below:



ACCESSORIES

Bow Handles



Cam Lock and Keeps



Finger Pulls

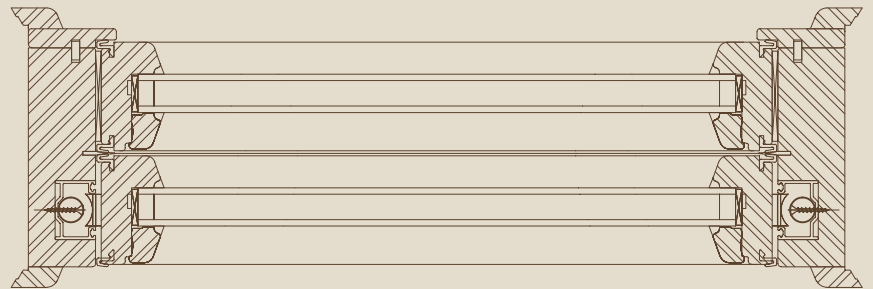
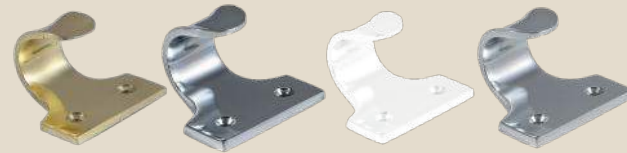

ACCESSORIES

All the accessories that, in a way, give life to a window are selected with care according to the technical requirements. What is left to the customers is only to select a handle according to her particular taste. In this section, you can make the color selection of our standard handles.



*"False" antique
espagnolette serving as
a handle to move the
real one.*

Rhapsody Bronze



Rhapsody Silber



Rhapsody Weiss



Rhapsody Champagne



Rhapsody Titan



Harmony Bronze



Harmony Weiss



Harmony Champagne



Harmony Titan

AUXILIARY WOODEN ELEMENTS

Border Profiles and Mouldings

It is possible to cover the joints between windows and adjacent walls both by means of simple border profiles and by decorative mouldings.

Our casings and frames made of “real wood” are important elements that differentiate our doors from artificial alternatives.

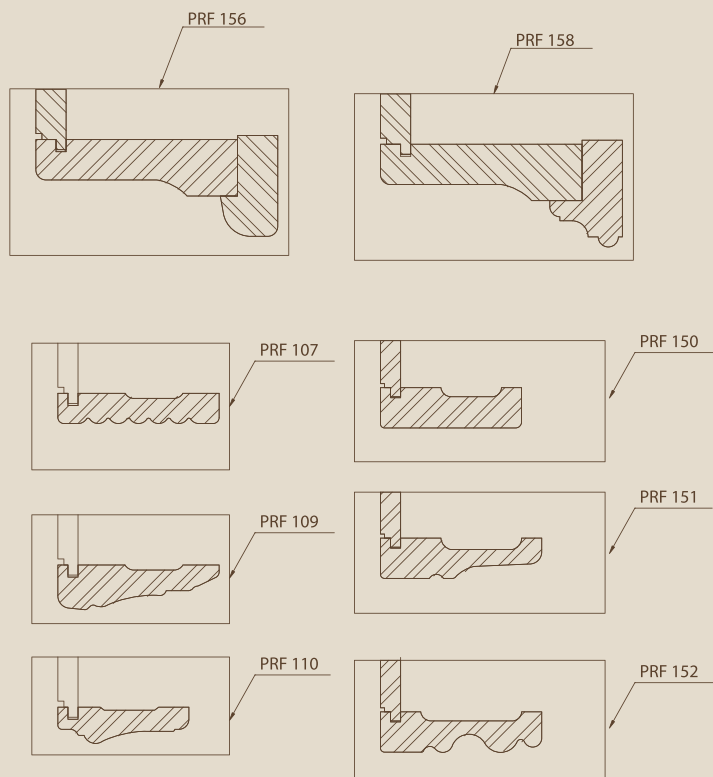

Corner Block and Header

Some people may not find the elegance achieved by a moulded casing sufficient. In this case decorative corner blocks or moulded headers may be added which will make a door the focus of home decoration.

Sills

Different sill options are available to connect the window with the below adjacent wall.

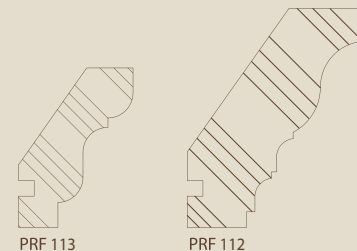

ENTRANCEDOORS

R-R solid wood doors have an astonishingly rich variety of models. All designs are aimed to carry the distinctive character of solid wood.

Another distinction of our door range, when compared to spaced panel or fiberboard doors, is the attractive look of auxiliary-components such as the jamb and head of door frames.

In the pictures here, you will find our current models and their corresponding codes. In the context of standard production, it is possible to change the wooden panels with glass or vice-versa. Demands for stained glass are handled in the scope of special production.

All models are available in

- 68 s, 78s and 90 s series,
- MODERN DESIGN and
CLASSIC DESIGN sections
- PINE RED GRANDIS and Oak
- R-R stains and RAL colours



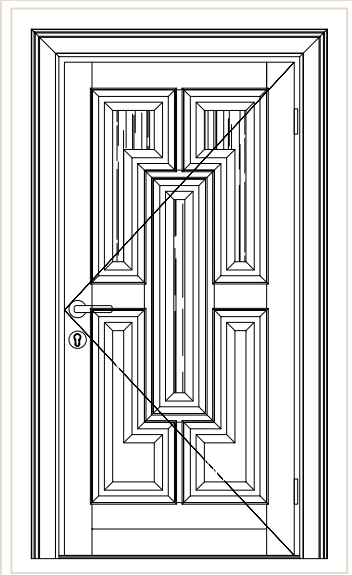

01

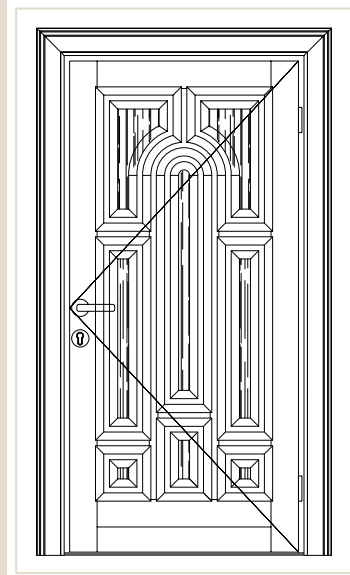

02

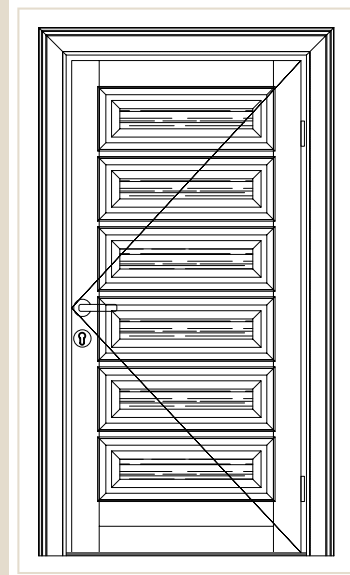

03

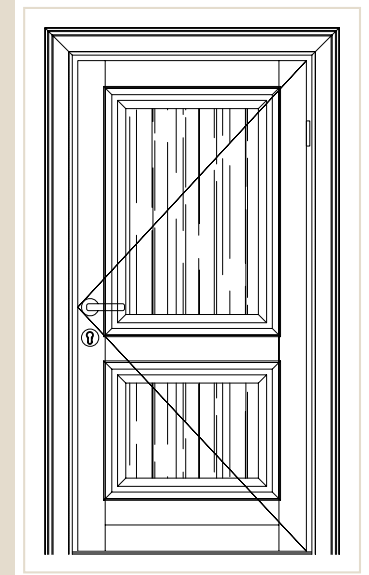

04

23

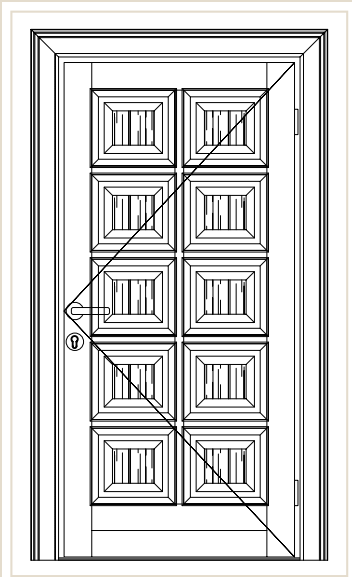

05

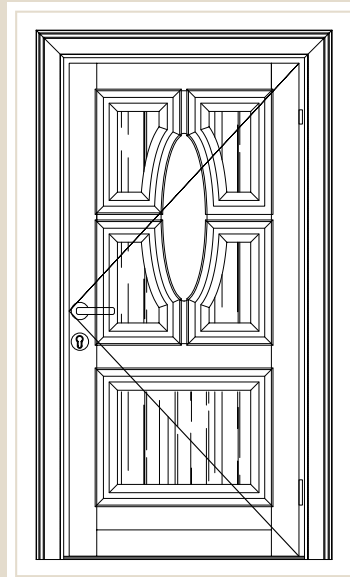

06

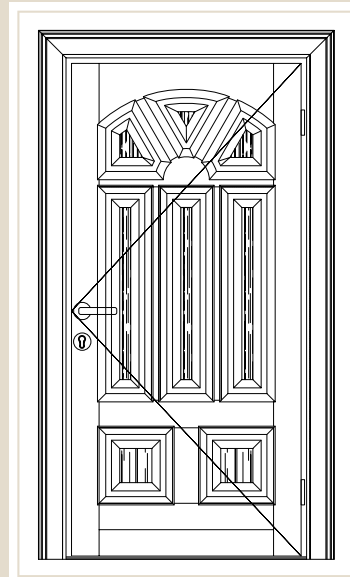

07

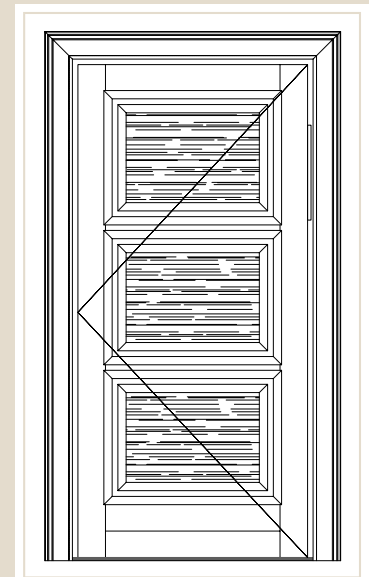

08

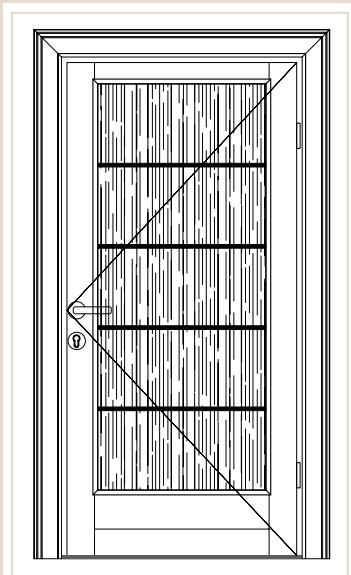

09

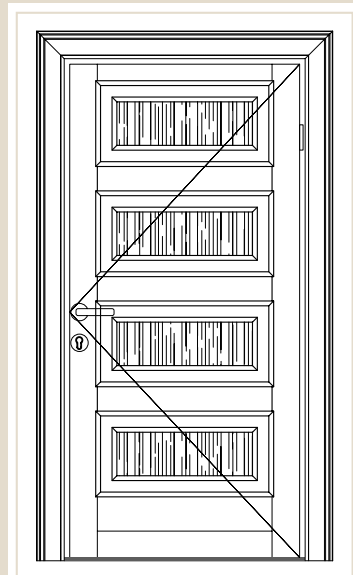

10

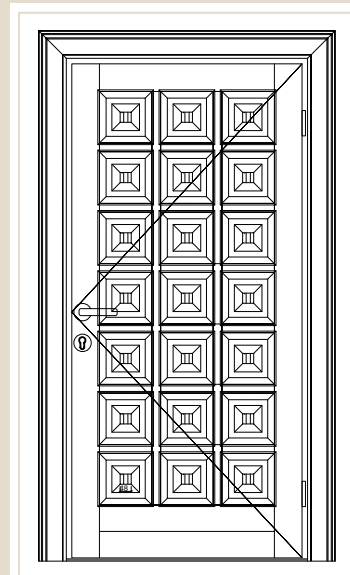

11

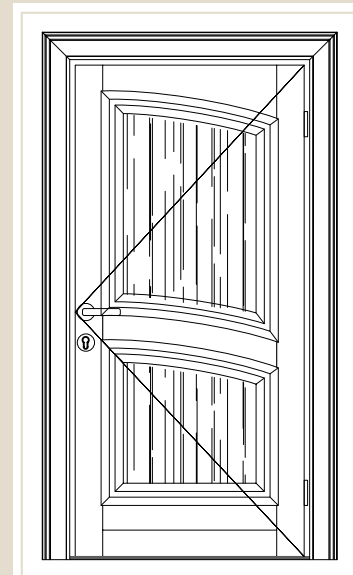

12

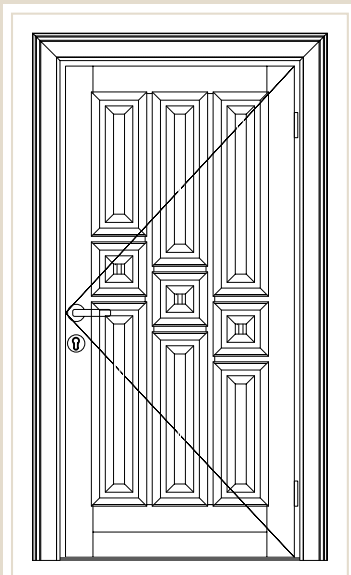

13

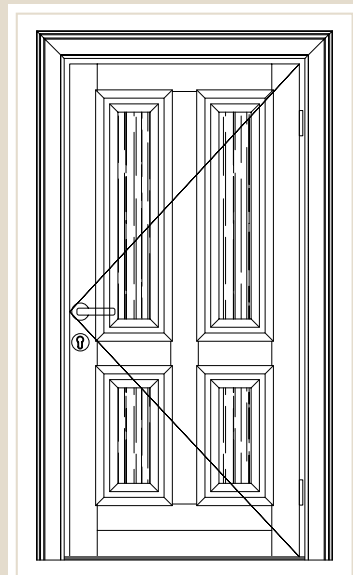

14

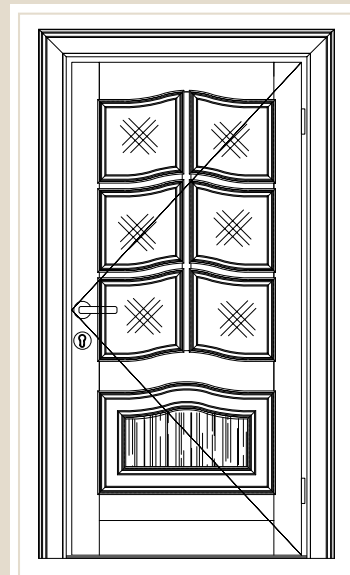

15

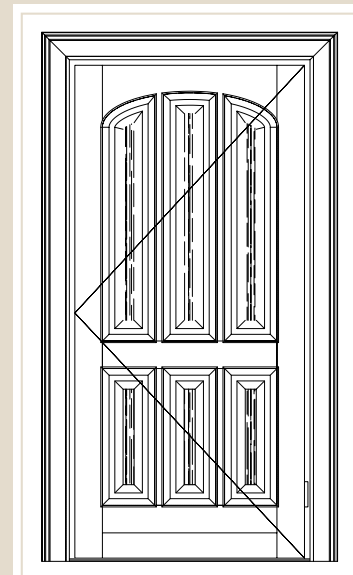

16

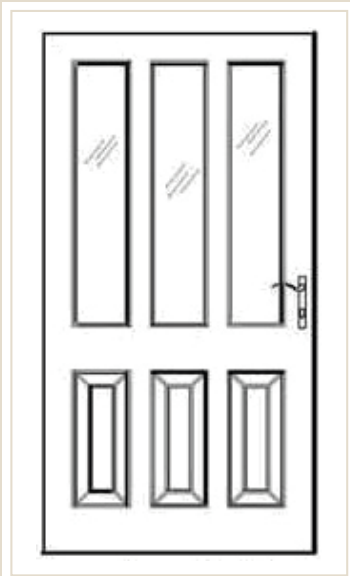

17

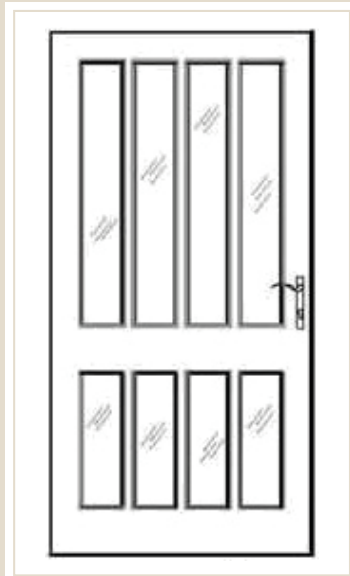

18



19

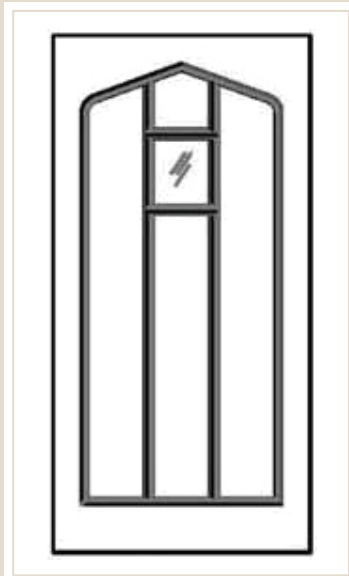

20

25



21



22



23

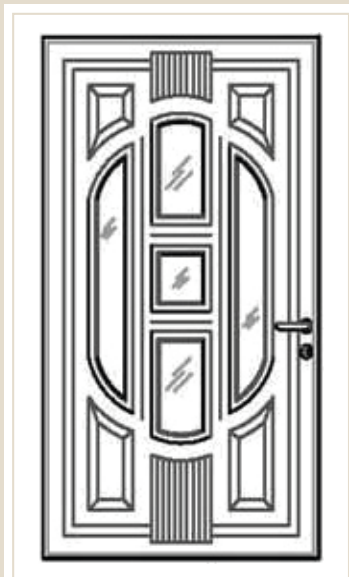

24

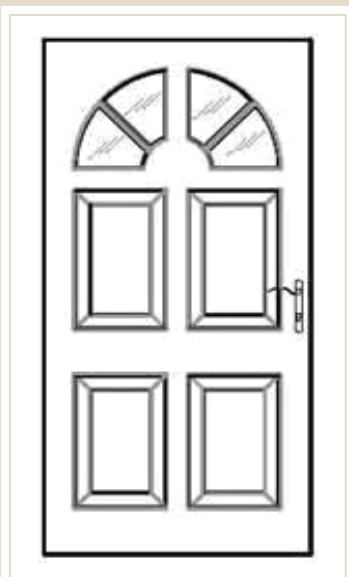

25

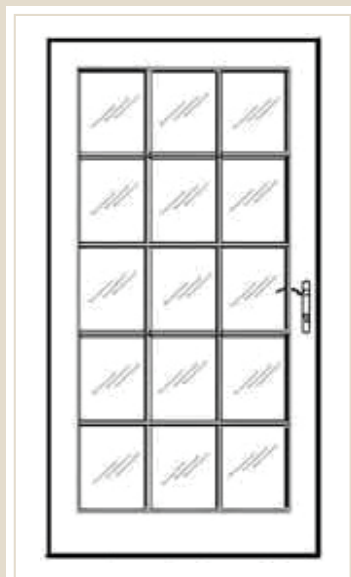

26

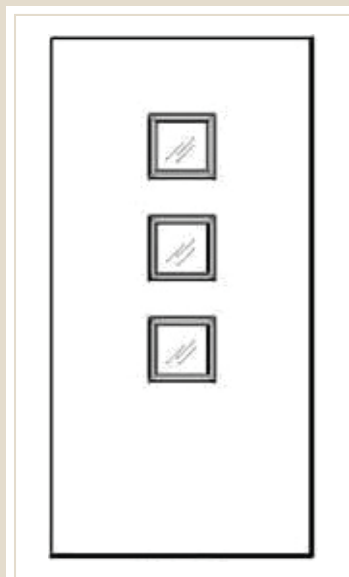

27

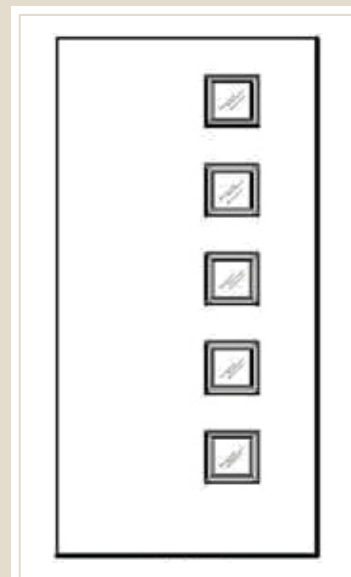

28

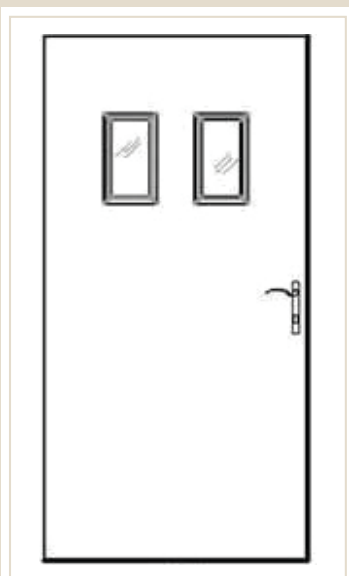

29

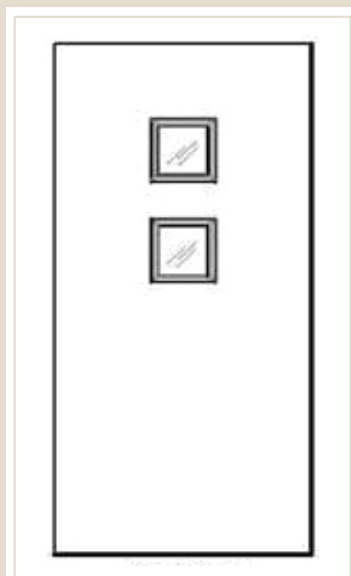

30

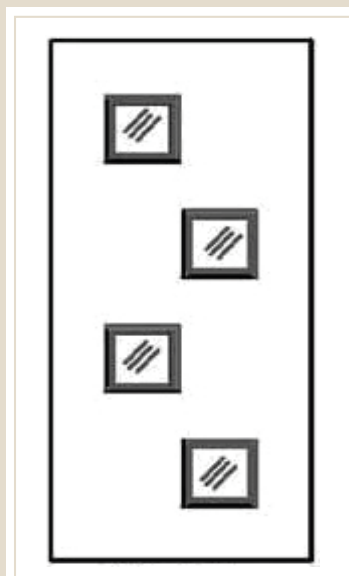

31



32

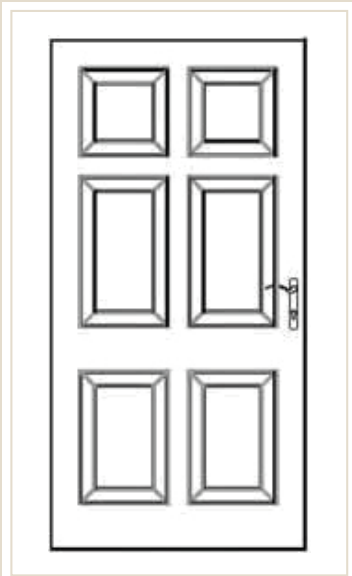

33

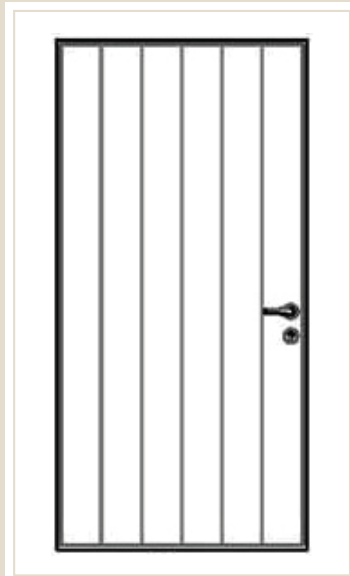

34

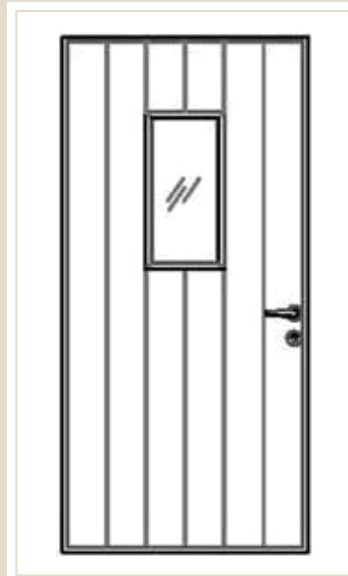

35

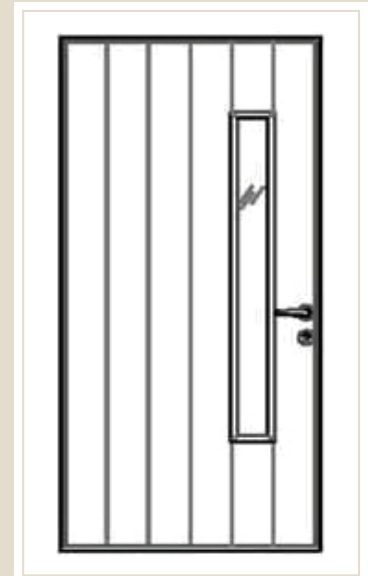

36

27

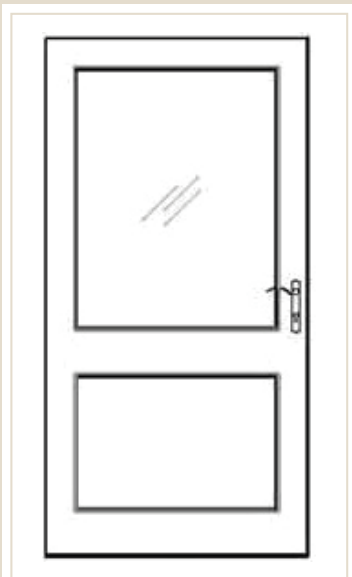

37



38

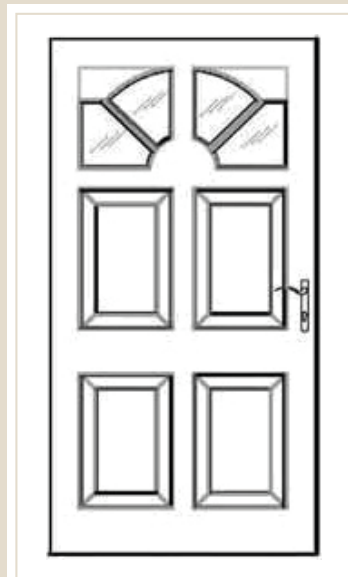

39

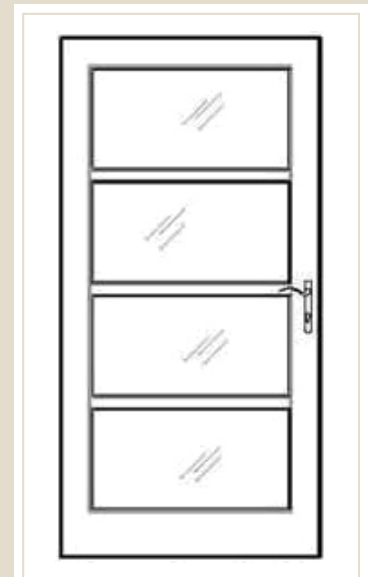

40

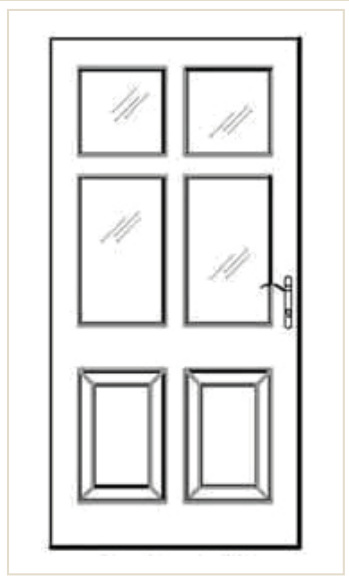

41

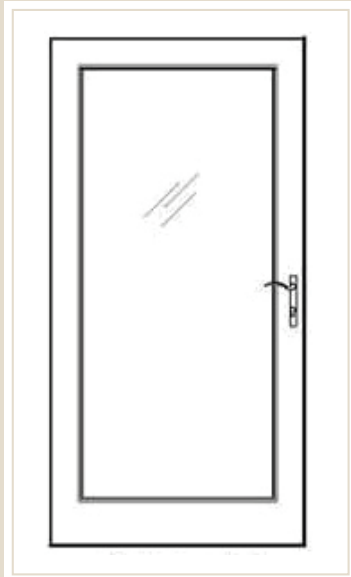

42

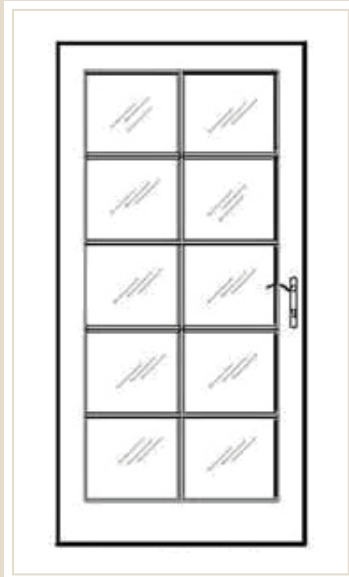

43

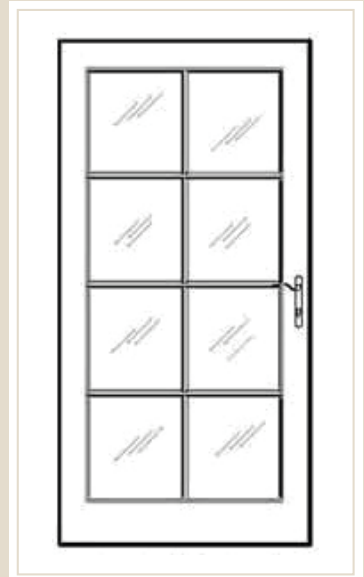

44

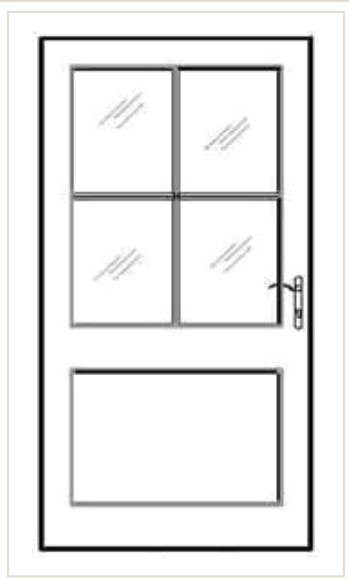

45

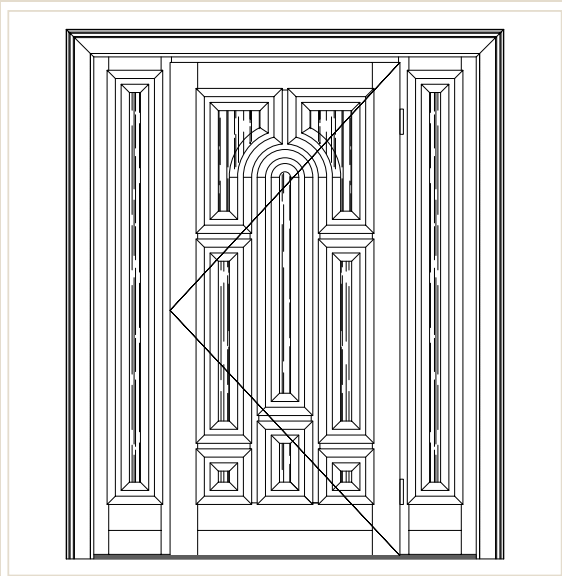

02YY

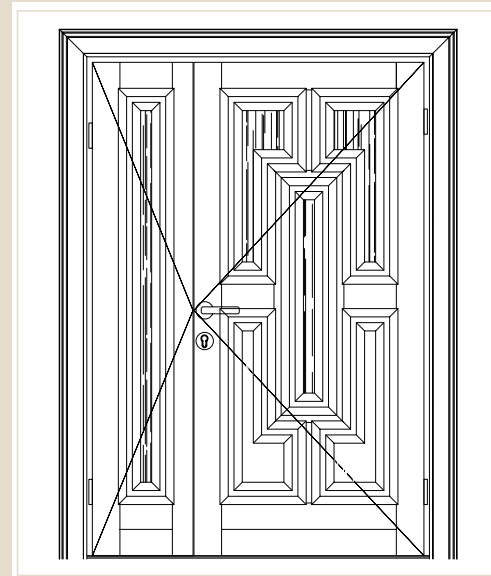

01Y

29

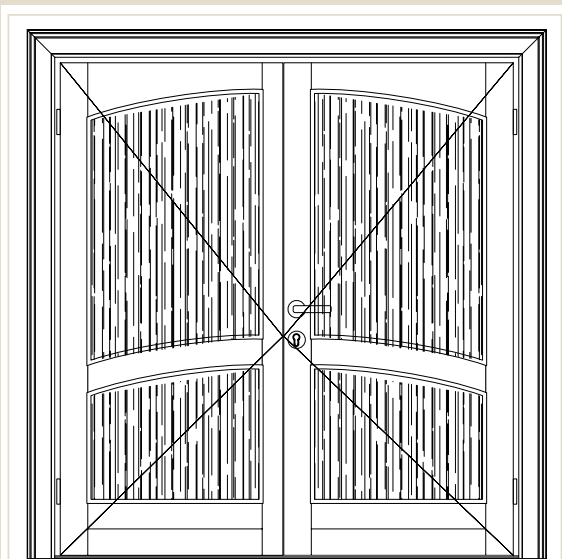

12-2

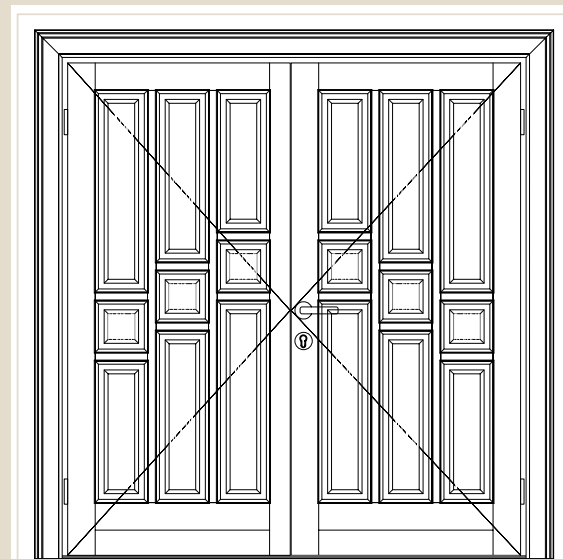

13-2

SECTIONS

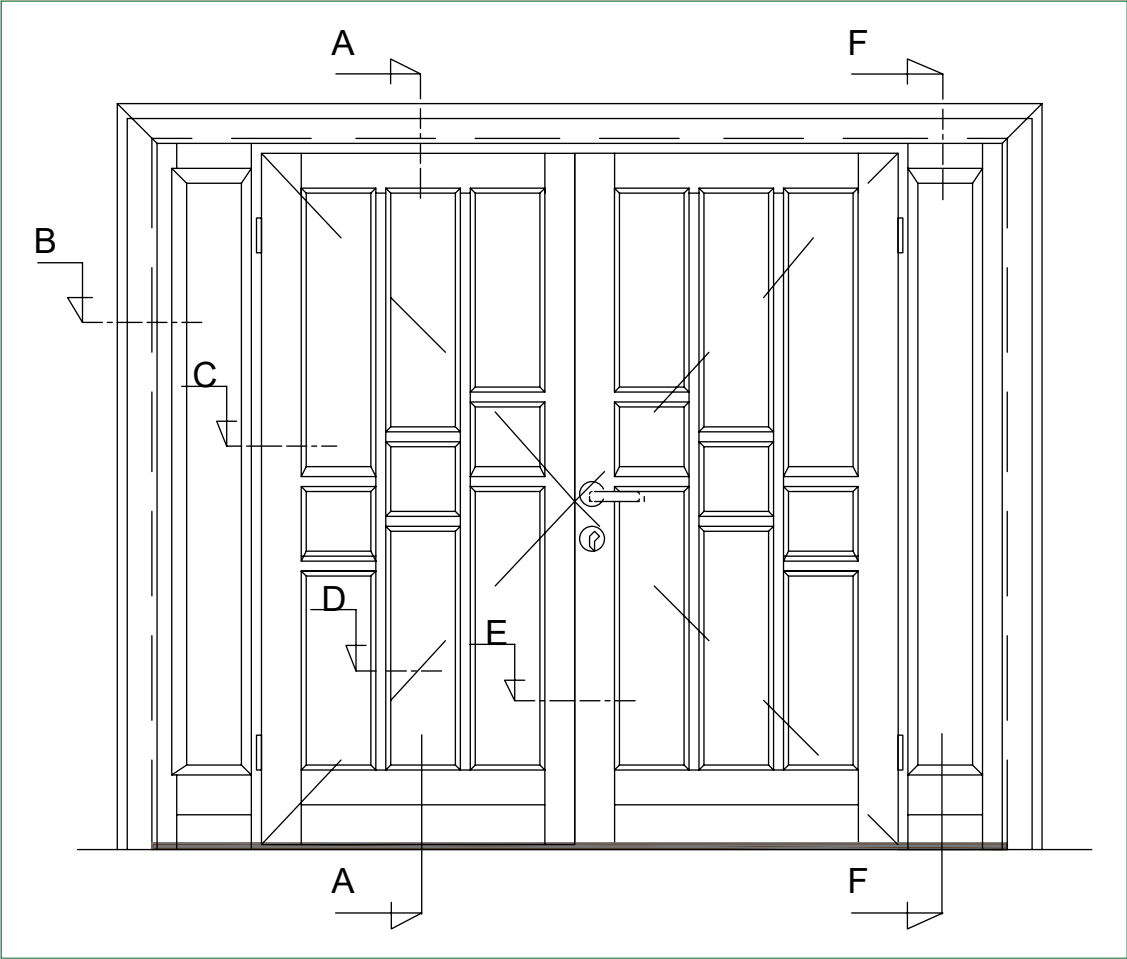

CLASSICDESIGN

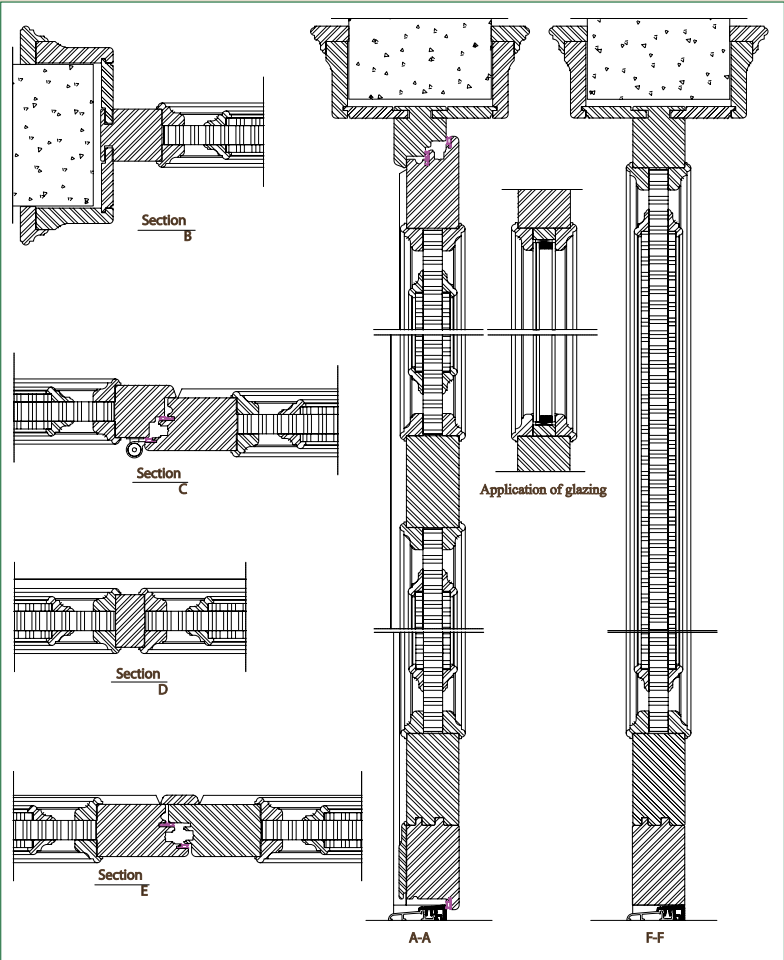

MODERNDESIGN

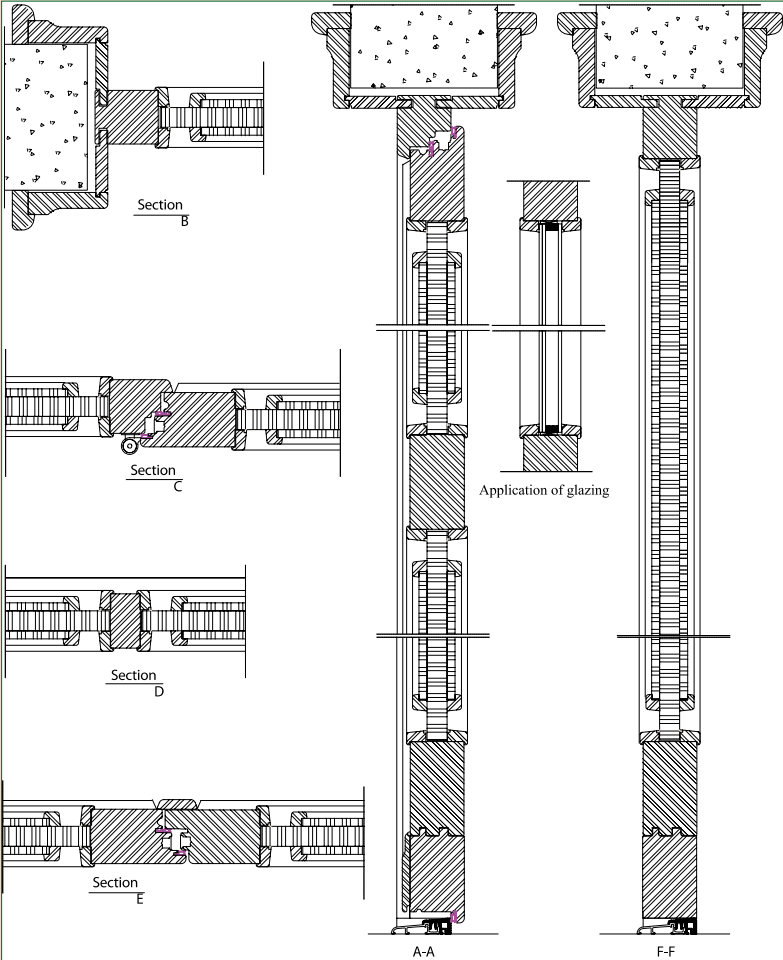

DOORHANDLES

All the hardware that, in a way, give life to a door are selected with care to the technical requirements. What is left to the customers is only to select the door knob and door handle according to her particular taste. In this section, you can make the color selection of our standard door knobs and handles.



Linea



Sogut



Anna

Accessories are available in Chrome, Nickel color options.

INTERIOR DOORS

Time to Build solid wood doors have an astonishingly rich variety of models. All designs are aimed to carry the distinctive character of solid wood.

In the pictures here, you will find our current models and their corresponding codes. In the context of standard production, it is possible to change the wooden panels with glass or vice-versa. Demands for stained glass are handled in the scope of special production.

Our interior doors are made of RED GRANDIS and painted in RAL colours.



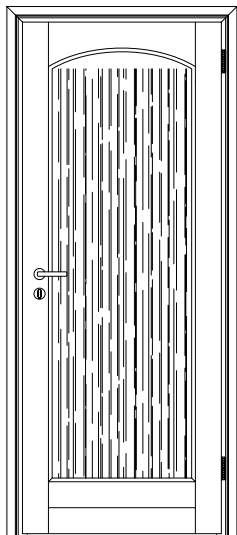

C01

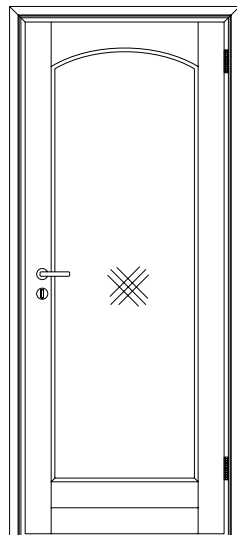

C02

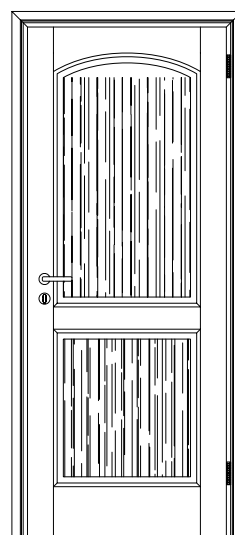

C03

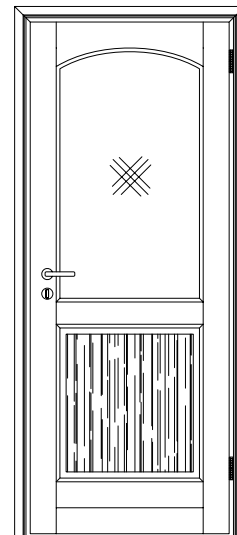

C04

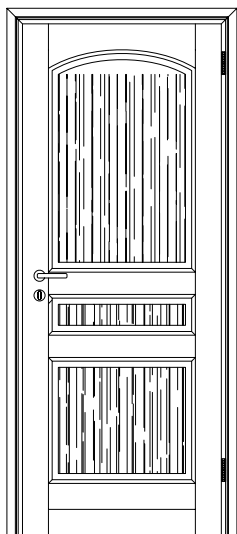

C05

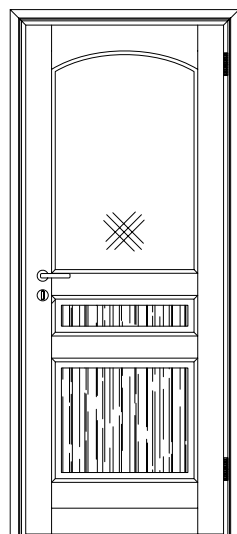

C06

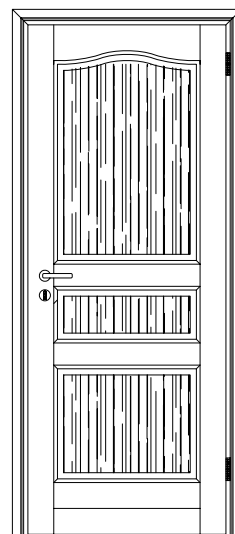

C07

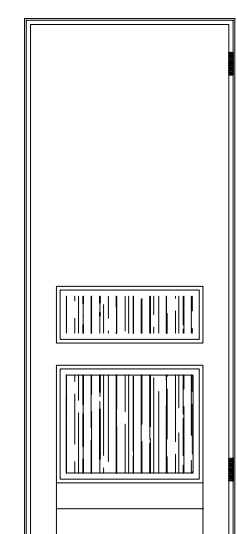

C08

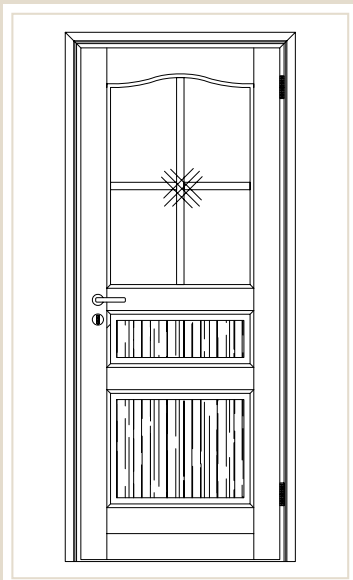

C09

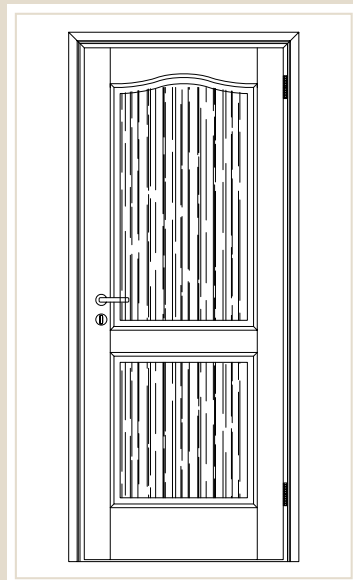

C10

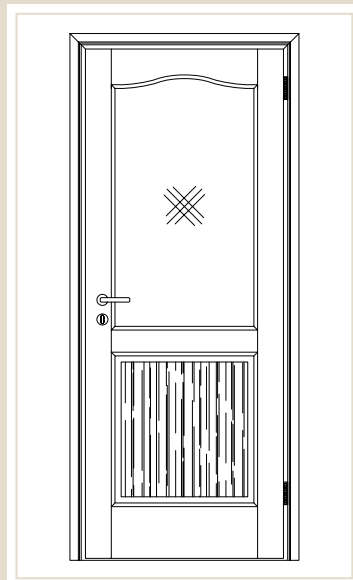

C11

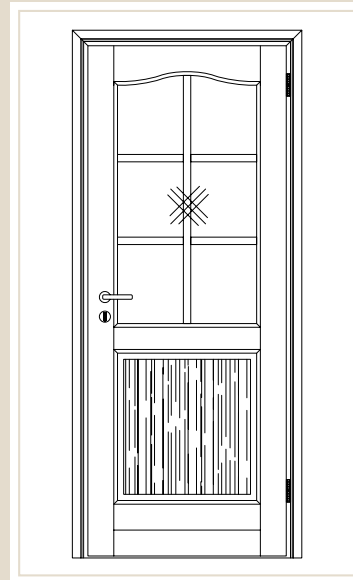

C12

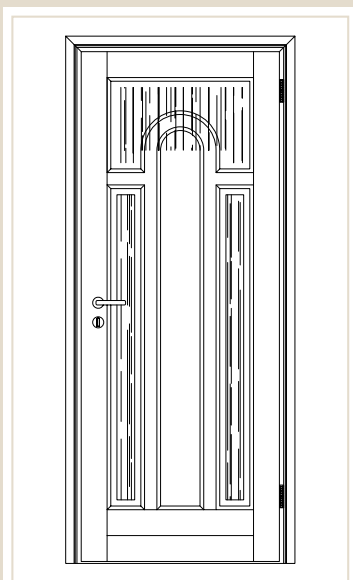

C13

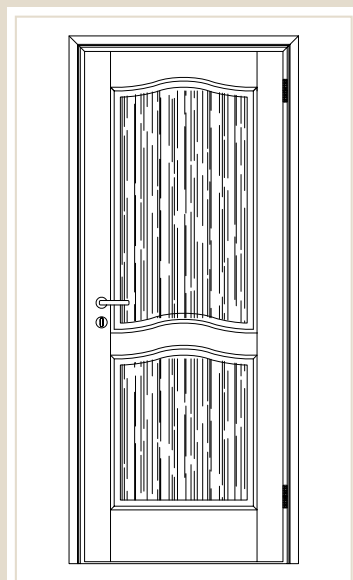

C14

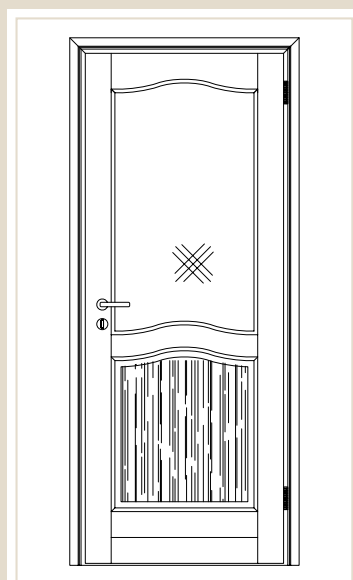

C15

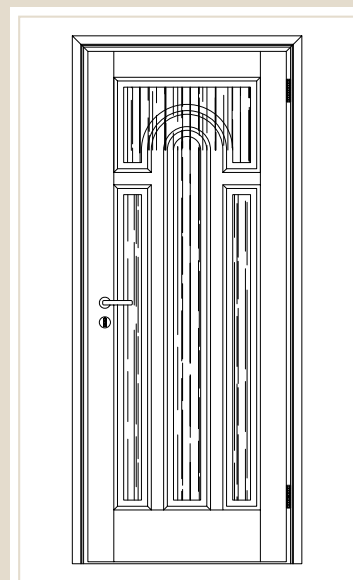

C16

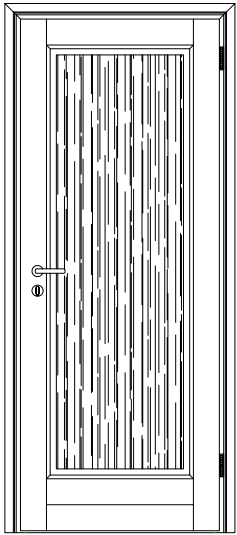

M01

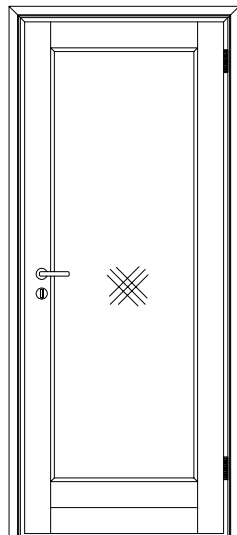

M02

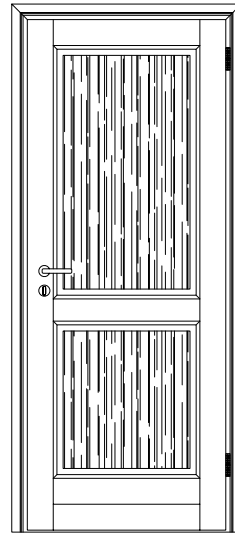

M03

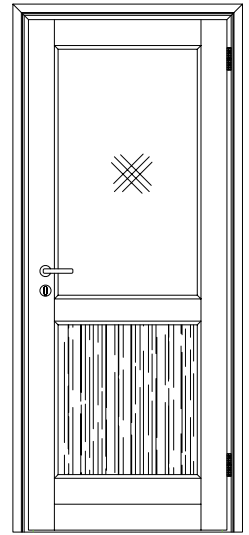

M04

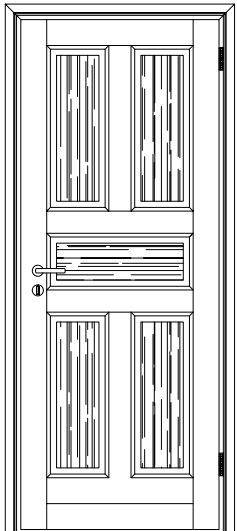

M05

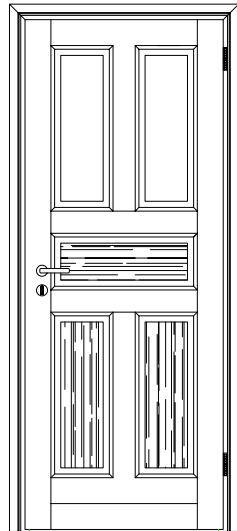

M06

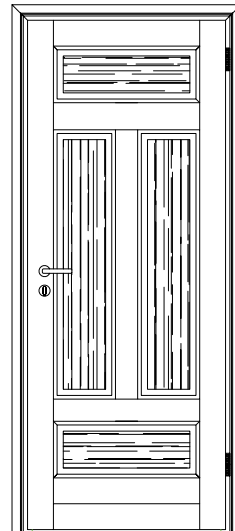

M07

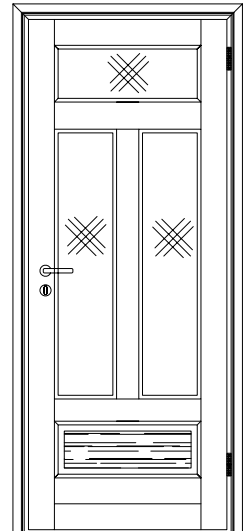

M08

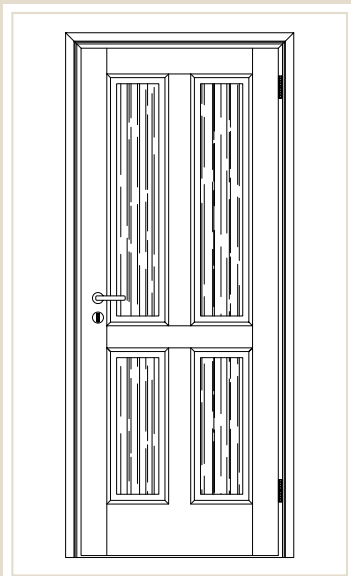

M09

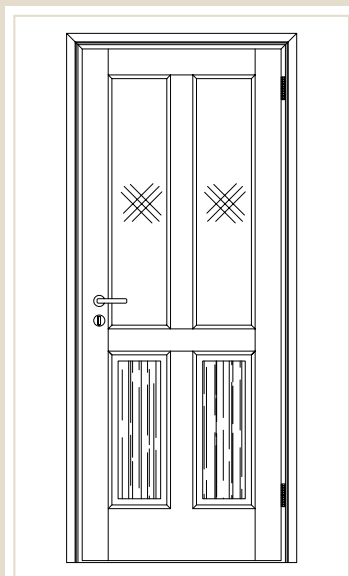

M10

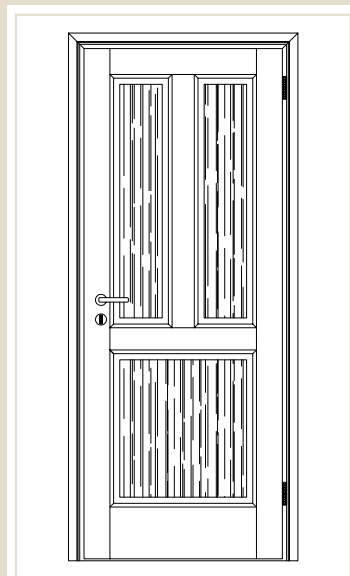

M11

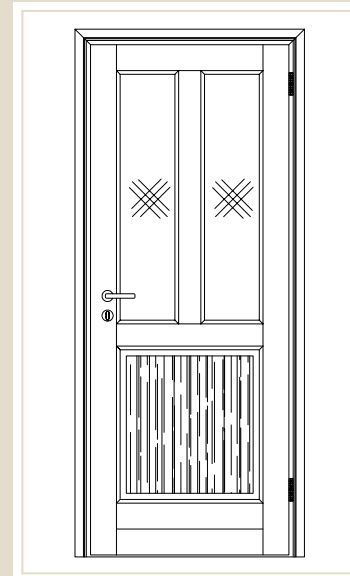

M12

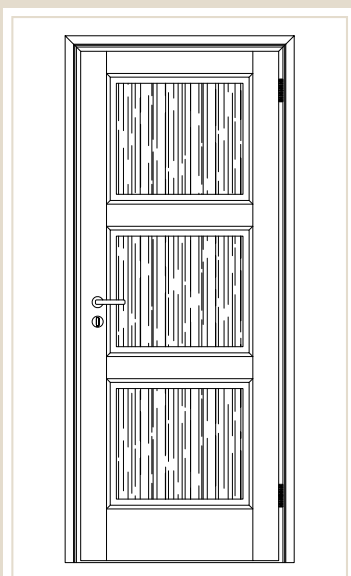

M13

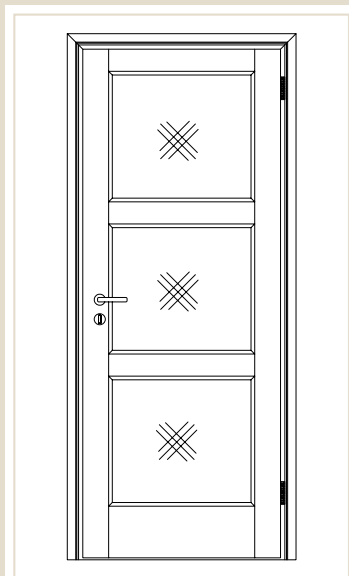

M14

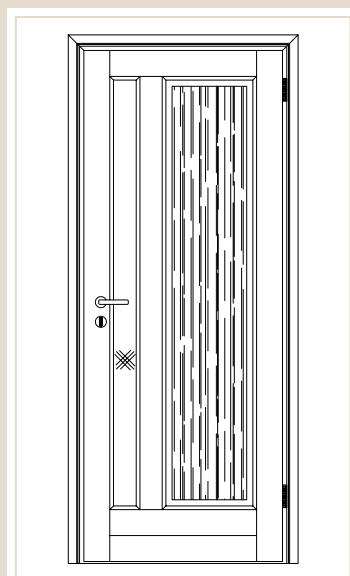

M15

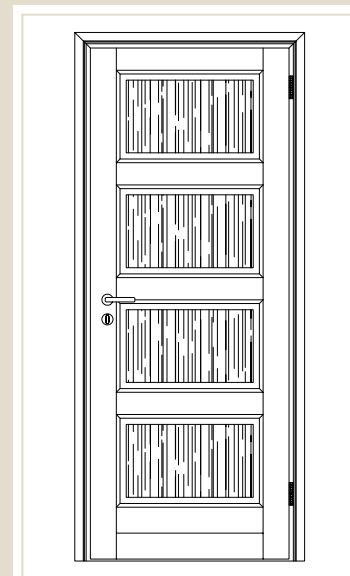

M16

SECTIONS

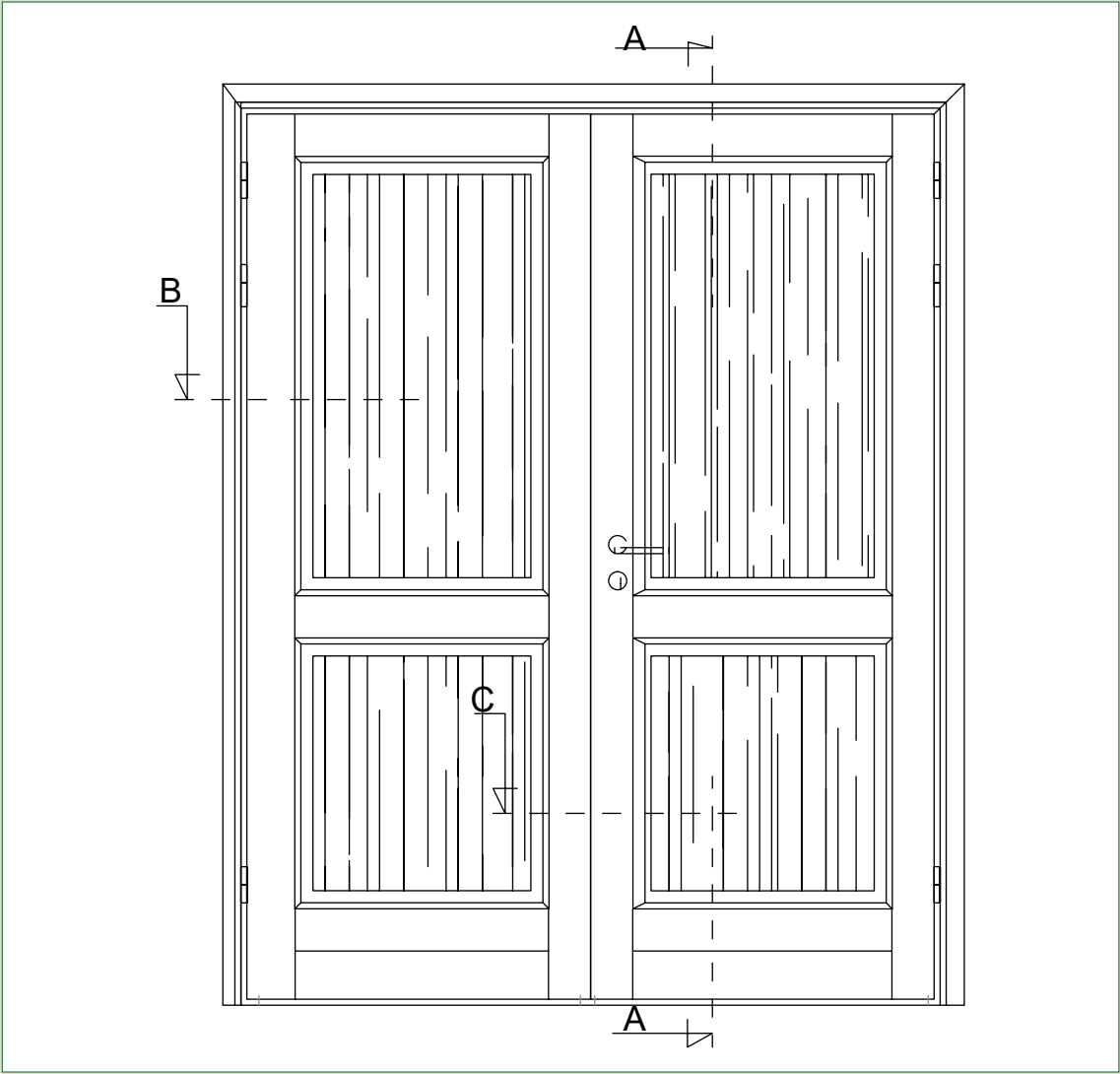

CLASSICDESIGN

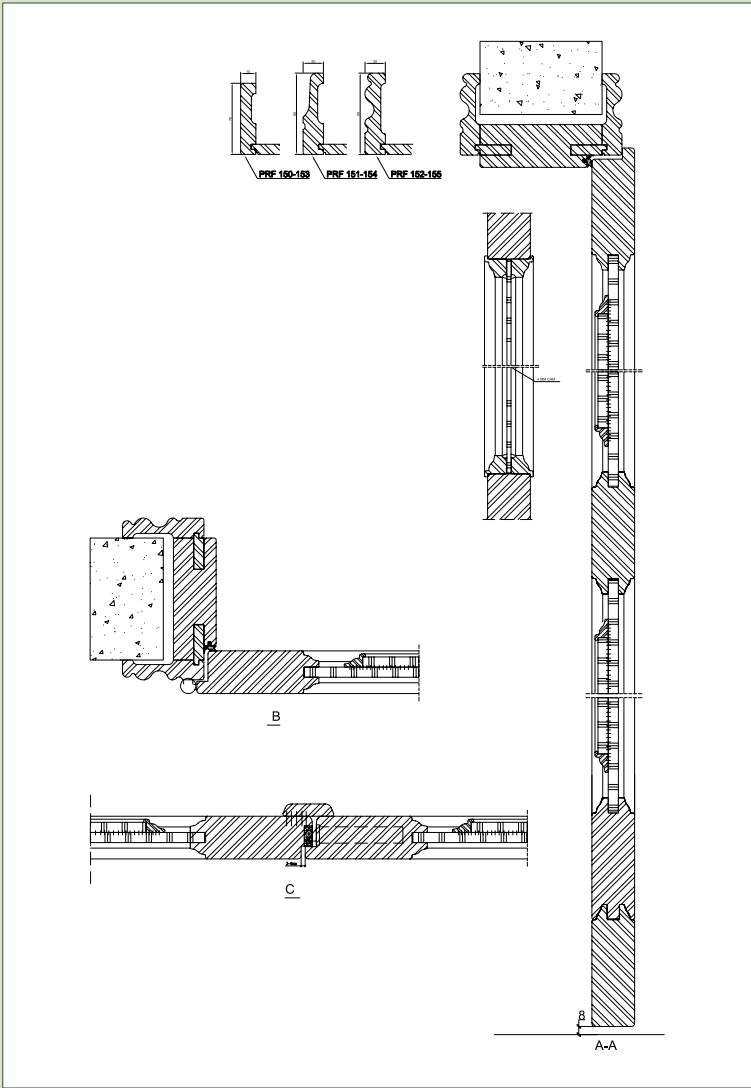

MODERNDISIGN

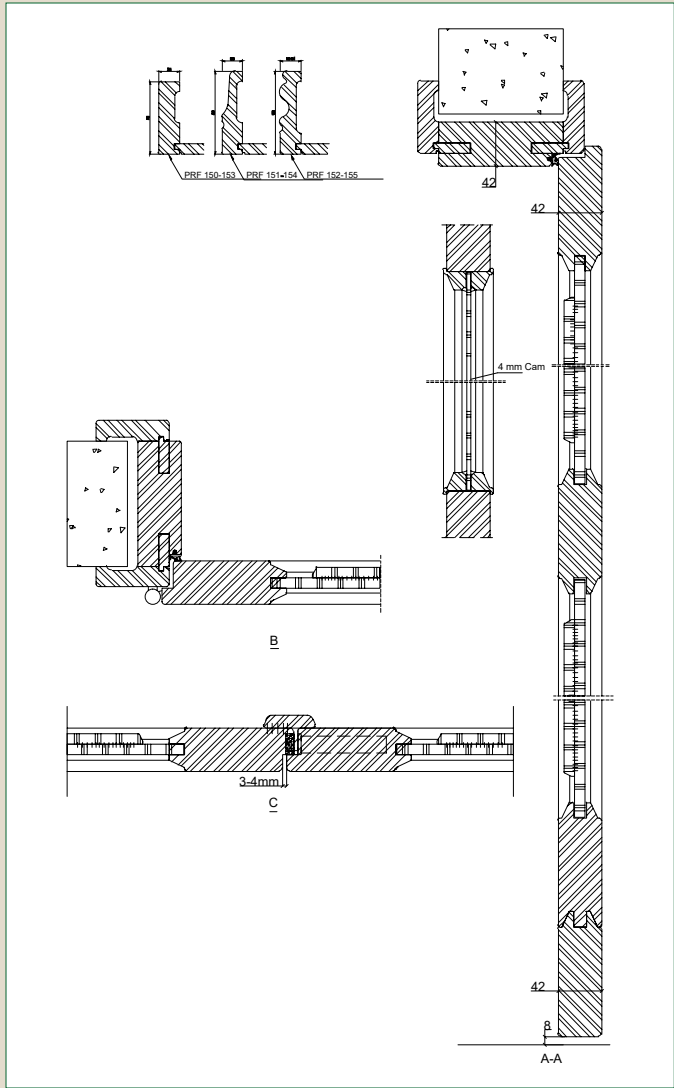

PLATON



WERNER-K

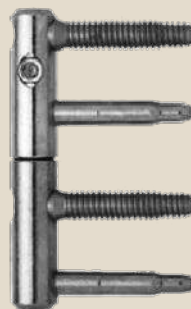

M05



M06

SUSTAINABLY SOURCED WOOD...

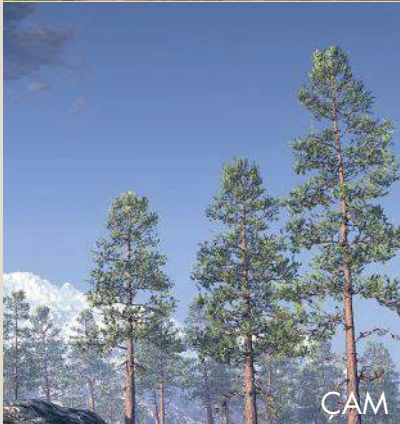

Time to Build sources wood material from suppliers who have chain-of-custody certification by PEFC and FSC.

There are more than 5.000 tree species in the world, with different densities and other distinct properties in mechanical, thermal, acoustic and biochemical terms.

We prefer pine among conifers, dark red Red Grandis among tropicals and oak among traditional wood species. Premium quality, 3 layers laminated wood scantlings, under 12 % moisture content are used in production. All three wood species are stable in terms of deformation against temperature and humidity fluctuations. They provide excellent surface and are suitable for industrial processing.

Red Grandis, unlike many tropical species is a product of sustainable forestry and is available in standard properties. Pine is surprisingly versatile, behaving like high density woods despite its low density.



STAINCOLOURS

42



AFROMOSIA



JADE



WALNUT



MAHOGANY



OAK



TEAK

Paint colours may be chosen from the complete RAL range.



TIME to
BUILD

*A finished project:
73 Residences with
Low Energy Consumption
in Nancy / France.*

HESITATIONS ABOUT WOOD

PROBLEM

Deformation:

Solid wood changing its shape due to changes on humidity and temperature.

Ordinary wood section



PROBLEM

Rotting:

Massive wood, in its natural form, is the main food of some bacteria, fungi and insects. Old fashioned paints, which form nonpermeable films, prevent breathing of wood but not rotting.

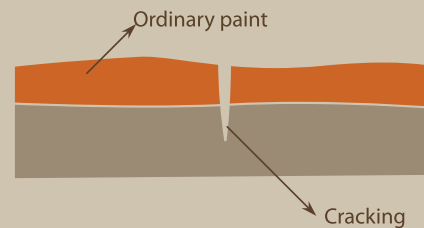

SOLUTION

Lamination Technique:

Three properly selected layers of solid wood are adhered in opposite working directions. Thus, twisting tendencies of each plate "reset" each other.

R-R Wood Section

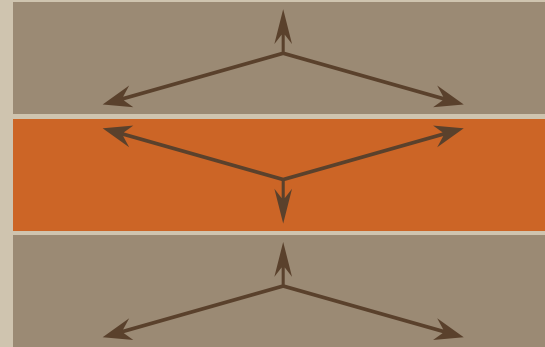

45

SOLUTION

Flexible Paint:

The surfaces of Time to Build products are coated with a flexible paint. This special paint which does not prevent wood of breathing (emitting and inhaling



Cracking







✉ info@qatartimetobuild.com

🌐 www.qatartimetobuild.com

📍 Doha, Qatar Unit No.: Office G31 Regus, Doha The Pearl Building 84,
Street 224, Area 66 Piazza Level, QO5A, Qanat Quartier The Pearl

